

TDS probe

EL18

Application and function

The TDS probe EL 18, mounted in the measuring flange, in connection with the TDS controller FARB2 and a TDS valve is a continuous regulation for boiler water with high TDS concentration.

Technical basic equipment

Mechanical connection	G ½ (SW27)	
Electrical connection	Plug connection with screw terminals, traction relief	
Material	Probe housing	stainless steel
	Probe rod	stainless steel
	Insulator	PTFE
	Socket	Polyamide
	Sealing ring	Soft iron
	Measuring flange	1.0460

Technical data

Allowable pressure	PS	[bar]	32
Allowable temperature	TS	[°C]	239
Cable gland	M16x1,5		
Protection as per DIN VDE 0470	IP65		
Allowable temperature on plug	100°C		

PS [bar]	DN	DIN	ø D	ø k	ø d
32	15	2527 Form B	95	65	14
	20		105	75	
	35		115	85	
	40		150	110	18

- Installation vertical to horizontal
- Other dimensions and materials up on request
- Screws, nuts and gaskets deliverable

Digital Documentation



Edition: 01/2020
Subject to change without a notice.

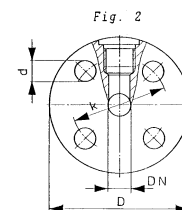
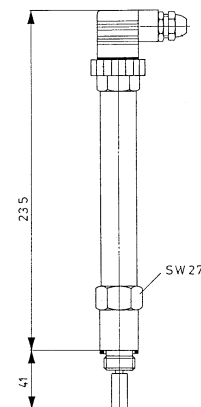

• production monitored